

A Community  
Supported Apiculture  
Scheme

Our adventure  
so far...

**bungay**  
*community*  
**bees**

# Beautiful Bees



# So what is a CSA model?



# Why use a CSA model?

- Support for one another as new beekeepers
- Accessibility for public involvement
- Financially supporting hives and beekeepers in an expensive business
- Innovation
- Ability to utilise the diverse strengths and interests of members
- Facilitating education and outreach practices
- More weight to apply for community grants

# Step 1: Form a plan



# The Initial Plan

- Recruit 25 members
- Subscription of £20 each
- Buy 2 National hives and 2 nuclei of bees
- Train 2 more beekeepers each year for 4 years
- Hold regular meetings
- Interested members to visit hives
- Share of any honey harvest
- Work towards sustainability

# Step 2: Allow it to catch the imagination



# Local Support

- Beechwood Bees (equipment)
- Bee inspector ( Beebase)
- Graham / Nicky Elliot (apiary and equipment)
- Hugh Watson (beekeeper)
- Keith / Jeannie Parker (apiary and meeting venue)
- Waveney Valley Beekeepers (initial training, answering our many questions, publicity, TV promotion, interest and enthusiasm)

# Getting the Children Involved



# Smoking the Entrance



# Feeling the Weight of a Frame of Nectar



**'Happy Birthday'**



**Step 3: Allow it to go where it wants to**



# Plants for Bees

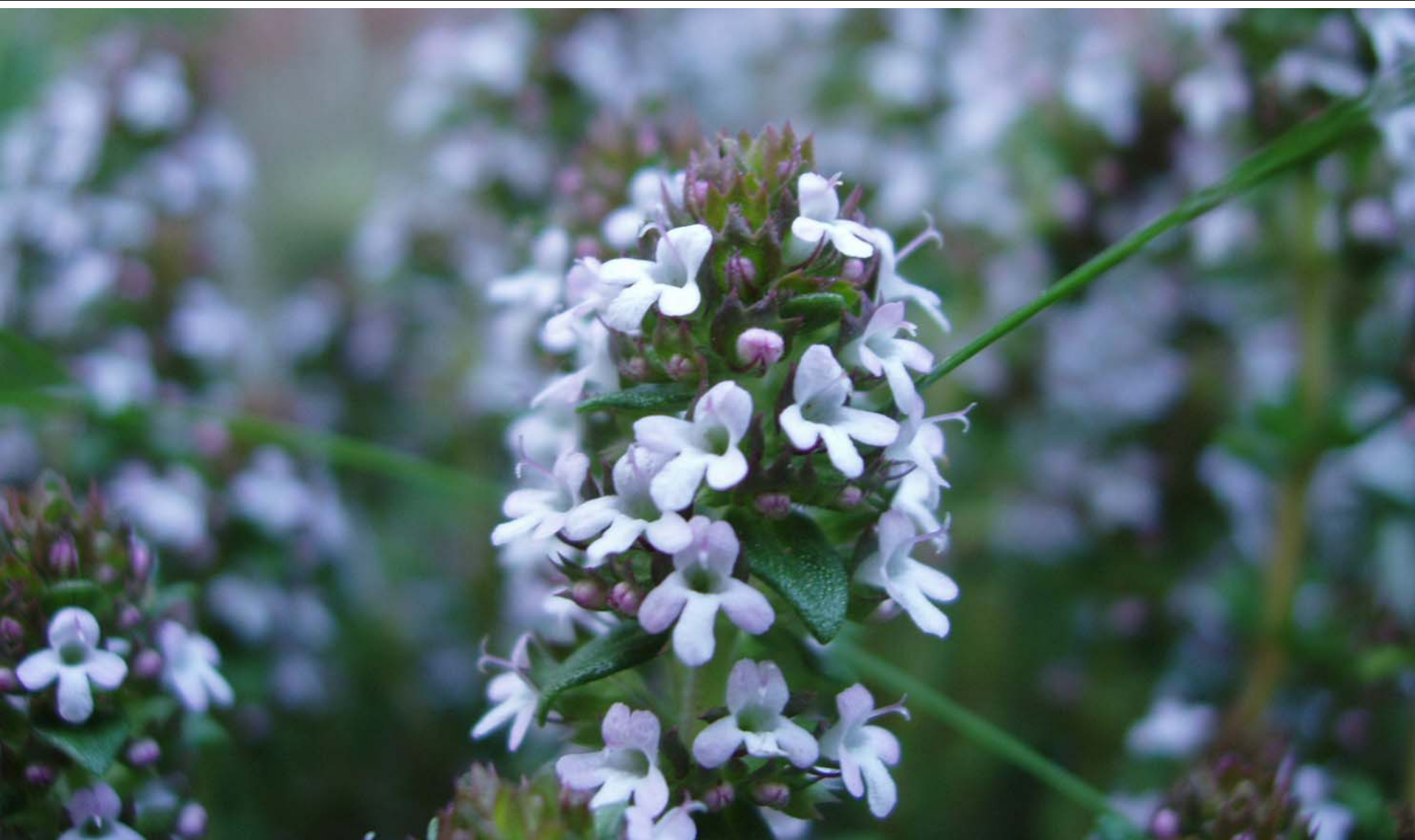

# Education and Outreach Group



# More sustainable beekeeping



# Bee-built comb



# TBH Design

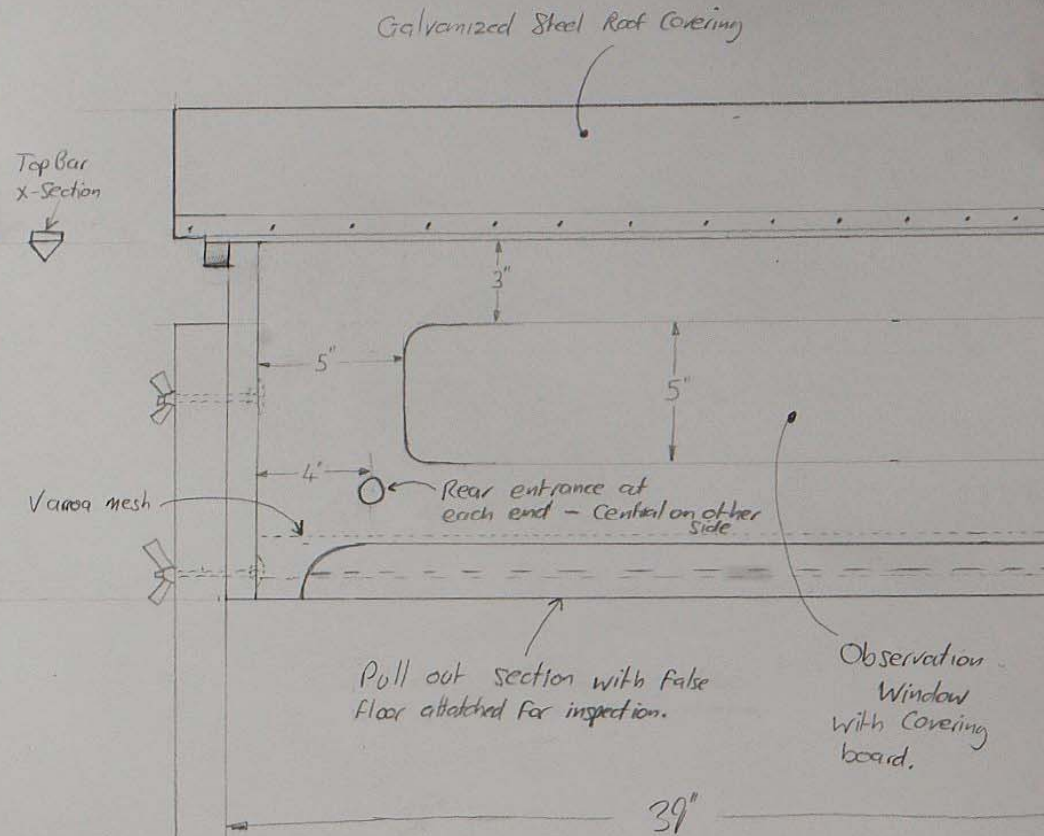
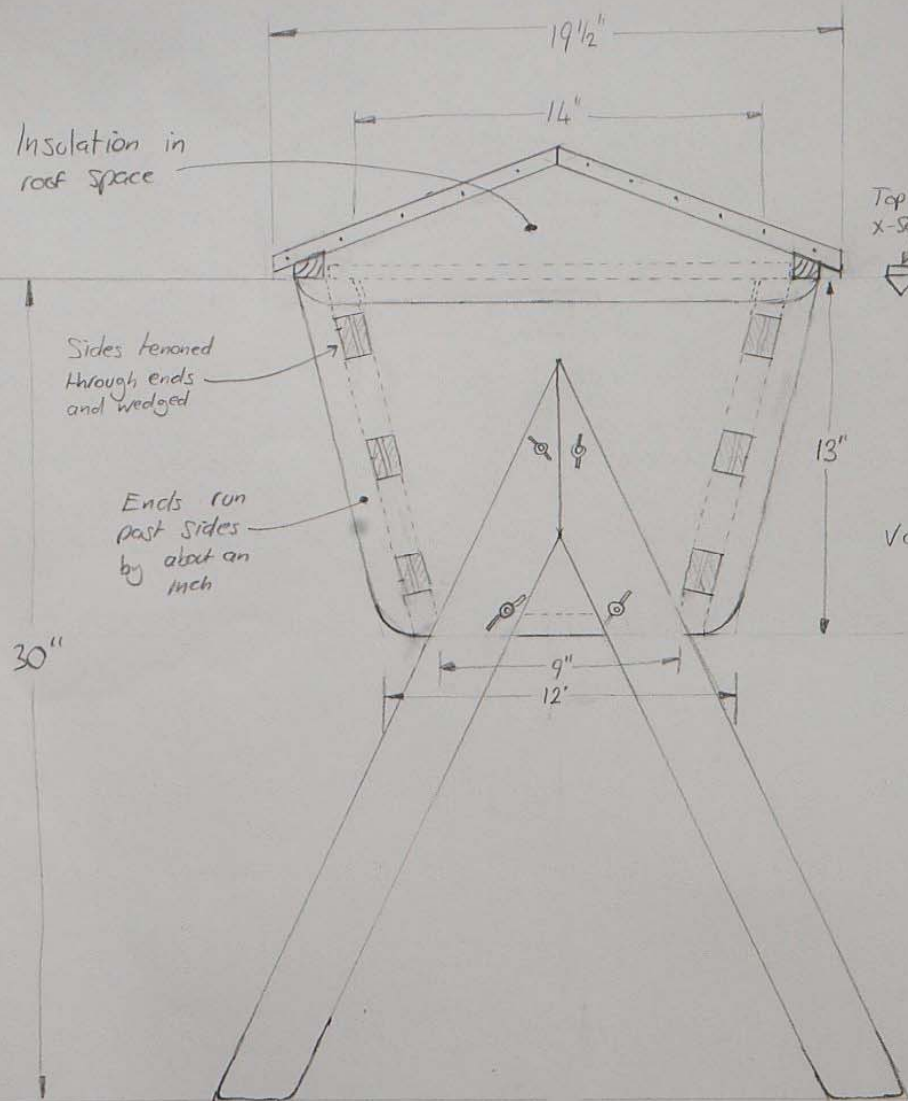

# Any Questions?



[www.sustainablebungay.com](http://www.sustainablebungay.com)